

Flexible Beam Coupling

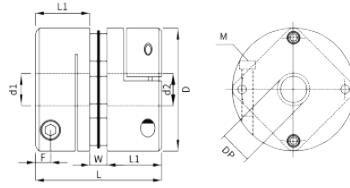

select	Inquiry	Type	D	L	d1~d2	W thickness	W inner hole	M	Tightening bolts Center to shaft end Distance	Tightening torque (N * m)	Rated torque (N * m)	Maximum torque (N * m)	Maximum speed (rpm)	Static torque rigidity (N * m/rad)	Radial deviation (mm)	Angular deviation (°)	Weight (g)
WQ-19*19	19	19	9	3~8	2	8	M2	3	1	1	2	10000	880	0.04	1.50	±0.18	24
WQ-26*26	26	26	12	4~11	3	11	M3	3.75	1.50	1.40	2.80	10000	950	0.04	1.50	±0.20	24
WQ-32*29	32	29	13	6~16	3	16	M3	3.50	1.50	2.80	5.60	10000	1960	0.04	1.50	±0.36	46
WQ-34*32	34	32	15	6~15	4	17	M4	5	1.50	2.80	5.60	10000	1960	0.04	1.50	±0.36	46
WQ-39*34	39	34	15.50	8~19	4	19	M4	4.75	2.50	5.80	11.60	10000	4500	0.04	1.50	±0.50	78
WQ-44*35	44	35	16	8~22	5	21	M4	4.75	2.50	8.70	17.40	10000	5100	0.04	1.50	±0.54	96
WQ-50*41	50	41	18	8~26	6	25.50	M5	5	7	25	50	10000	10500	0.04	1.50	±0.54	170
WQ-56*45	56	45	20	10~28	5	29	M5	5.75	7	25	50	10000	10500	0.04	1.50	±0.72	206
WQ-68*54	68	54	24	12~35	6	39	M6	6.75	12	55	110	9000	18500	0.04	1.50	±0.80	366
WQ-82*68	82	68	30	14~45	8	43	M8	8.25	16	80	160	8000	21800	0.04	1.50	±0.80	710
WQ-94*70	94	70	30	15-52	10	40	M8	8.65	16	165	330	8000	50000	0.04	1.50	±1.30	1170