

Widening Series

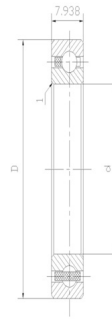

select	Inquiry	Bearing NO.	Shape Dimension							Basic Load Rating(N)		Weight (kg)
			d(mm)	d(inch)	D(mm)	D(inch)	B(mm)	B(inch)	r min(mm)	r min(inch)	Dynamic(Cr)	
63008	40	1.5748	68	2.6772	21	0.8268	1	0.0394	17030	11700	0.2590	
63007	35	1.3780	62	2.4409	20	0.7874	1	0.0394	16210	10420	0.2100	
63006	30	1.1811	55	2.1654	19	0.7480	1	0.0394	11900	7460	0.1590	
63005	25	0.9843	47	1.8504	16	0.6299	0.6	0.0236	10060	5860	0.1000	
63004	20	0.7874	42	1.6535	16	0.6299	0.6	0.0236	9390	5020	0.0880	
63003	17	0.6693	35	1.3780	14	0.5512	0.3	0.0118	6000	3250	0.0510	
63002	15	0.5906	32	1.2598	13	0.5118	0.3	0.0118	5590	2840	0.0420	
63001	12	0.4724	28	1.1024	12	0.4724	0.3	0.0118	5110	2380	0.0290	
63000	10	0.3937	26	1.0236	12	0.4724	0.3	0.0118	4160	1780	0.0250	
62310	50	1.9685	110	4.3307	40	1.5748	2	0.0787	62000	38500	1.4980	
62309	45	1.7717	100	3.9370	36	1.4173	1.5	0.0591	53000	32000	1.1560	
62308	40	1.5748	90	3.5433	33	1.2992	1.5	0.0591	40500	24000	0.8850	
62307	35	1.3780	80	3.1496	31	1.2205	1.5	0.0591	33500	19200	0.6470	
62306	30	1.1811	72	2.8346	27	1.0630	1.1	0.0433	27000	15200	0.4850	
62305	25	0.9843	62	2.4409	24	0.9449	1.1	0.0433	22380	11490	0.3200	
62304	20	0.7874	52	2.0472	21	0.8268	1.1	0.0433	15940	7880	0.1970	
62303	17	0.6693	47	1.8504	19	0.7480	1	0.0394	13580	6580	0.1490	
62302	15	0.5906	42	1.6535	17	0.6693	1	0.0394	11400	5430	0.1100	
62301	12	0.4724	37	1.4567	17	0.6693	1	0.0394	9700	4190	0.0740	
62300	10	0.3937	35	1.3780	17	0.6693	0.6	0.0236	7640	3470	0.0600	
62210	50	1.9685	90	3.5433	23	0.9055	1.1	0.0433	35000	23200	0.5200	
62209	45	1.7717	85	3.3465	23	0.9055	1.1	0.0433	31500	20400	0.4800	
62208	40	1.5748	80	3.1496	23	0.9055	1.1	0.0433	29520	18140	0.4400	
62207	35	1.3780	72	2.8346	23	0.9055	1.1	0.0433	25670	15300	0.3450	
62206	30	1.1811	62	2.4409	20	0.7874	1	0.0394	19460	11310	0.2420	
62205	25	0.9843	52	2.0472	18	0.7087	1	0.0394	14020	7930	0.1460	
62204	20	0.7874	47	1.8504	18	0.7087	1	0.0394	12840	6650	0.1280	
62203	17	0.6693	40	1.5748	16	0.6299	0.6	0.0236	9560	4780	0.0850	
62202	15	0.5906	35	1.3780	14	0.5512	0.6	0.0236	7450	3700	0.0560	
62201	12	0.4724	32	1.2598	14	0.5512	0.6	0.0236	6180	3060	0.0460	