

67 Super Thin Series

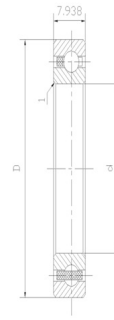

select Inquiry	Bearing NO.	Shape Dimension								Basic Load Rating(N)		Weight (kg)
		d(mm)	d(inch)	D(mm)	D(inch)	B(mm)	B(inch)	r min(mm)	r min(inch)	Dynamic(Cr)	Static(Cor)	
6700	10	0.3937	15	0.5906	4	0.1575	0.1	0.0039	800	390	0.0019	
6701	12	0.4724	18	0.7087	4	0.1575	0.2	0.0079	910	530	0.0031	
6702	15	0.5906	21	0.8268	4	0.1575	0.2	0.0079	850	490	0.0036	
6703	17	0.6693	23	0.9055	4	0.1575	0.2	0.0079	960	610	0.0040	
6704	20	0.7874	27	1.0630	4	0.1575	0.2	0.0079	1030	720	0.0059	
6705	25	0.9843	32	1.2598	4	0.1575	0.2	0.0079	1090	830	0.0070	
6706	30	1.1811	37	1.4567	4	0.1575	0.2	0.0079	1170	980	0.0083	
6707	35	1.3780	44	1.7323	5	0.1969	0.3	0.0118	1850	1630	0.0150	
6708	40	1.5748	50	1.9685	6	0.2362	0.3	0.0118	2519	2234	0.0230	
6709	45	1.7717	55	2.1654	6	0.2362	0.3	0.0118	2577	2401	0.0250	
6710	50	1.9685	62	2.4409	6	0.2362	0.3	0.0118	2666	2636	0.0340	