

16000 Series

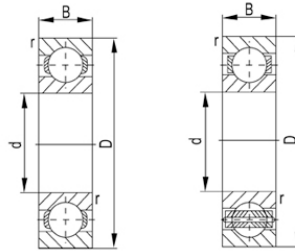

select	Inquiry	Bearing No.	Boundary dimensions □mm□				rs min	Basic load ratings(kN)		Limiting speed(rpm Mass)	
			d	D	B	Dynamic(Cr)		Static(Cor)	Grease	Oil	Kg
16001	12	28	7	0.3	5.1	2.39	26000	30000	0.019		
16002	15	32	8	0.3	5.6	2.83	22000	26000	0.025		
16003	17	35	8	0.3	6.8	3.35	20000	24000	0.032		
16004	20	42	8	0.3	7.9	4.5	18000	21000	0.051		
16005	25	47	8	0.3	8.35	5.1	15000	18000	0.06		
16006	30	55	9	0.3	11.2	7.35	13000	15000	0.091		
16007	35	62	9	0.3	11.7	8.2	12000	14000	0.11		
16008	40	68	9	0.3	12.6	9.65	10000	12000	0.125		
16009	45	75	10	0.6	12.9	10.5	9200	11000	0.171		
16010	50	80	10	0.6	13.2	11.3	8400	9800	0.18		
16011	55	90	11	0.6	18.6	15.3	7700	9000	0.258		
16012	60	95	11	0.6	20	17.5	7000	8300	0.283		
16013	65	100	11	0.6	20.5	18.7	6500	7700	0.307		
16014	70	110	13	0.6	24.4	22.6	6100	7100	0.441		
16015	75	115	13	0.6	25	24	5700	6700	0.464		
16016	80	125	14	0.6	25.4	25.1	5300	6200	0.597		
16017	85	130	14	0.6	25.9	26.2	5000	5900	0.626		
16018	90	140	16	1	33.5	33.5	4700	5600	0.848		
16019	95	145	16	1	34.5	35	4500	5300	0.885		
16020	100	150	16	1	35	36.5	4200	5000	0.91		

16000 Series

16021	105	160	18	1	52	50.5	4000	4700	1.2
16022	110	170	19	1	57.5	56.5	3800	4500	1.46
16024	120	180	19	1	63	63.5	3500	4100	1.56
16026	130	200	22	1.1	80	79.5	3200	3800	2.31
16028	140	210	22	1.1	82	85	3000	3500	2.45
16030	150	225	24	1.1	96.5	101	2800	3200	3.07
16032	160	240	25	1.5	99	108	2600	3000	3.64
16034	170	260	28	1.5	119	128	2400	2800	4.93
16036	180	280	31	2	117	134	2300	2700	6.49
16038	190	290	31	2	134	156	2100	2500	6.77