

Single-row Four Point Contact Ball Slewing Bearing (External gear type)

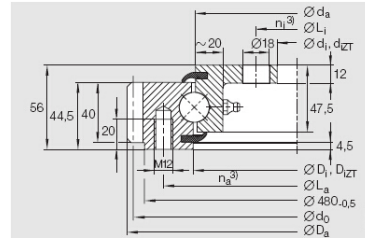
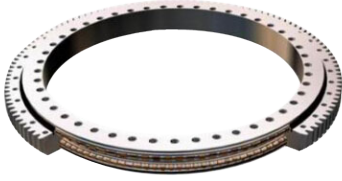

select	Inquiry Designations	Boundary Dimension [mm]	Bolt Hole Diameter [mm]				Weight				
			Da	Di	H	La	Li	na3)	ni3)	m	z
E.505.20.00.C	503.3	304	56	455	332	10	12	5	99	29.5	
E.650.20.00.C	640	434	56	585	462	14	14	6	105	41.5	
E.750.20.00.C	742	534	56	685	562	16	16	6	122	48.5	
E.850.20.00.C	838	634	56	785	662	18	16	6	138	54.5	
E.950.20.00.C	950	734	56	885	762	18	18	8	117	65.5	
E.1050.20.00.C	1046	834	56	985	862	20	20	8	129	71.5	
E.1200.20.00.C	1198	984	56	1135	1012	22	20	8	148	83.5	