

英制不锈钢深沟球轴承

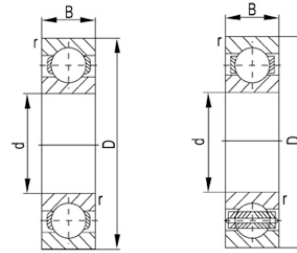

select	Inquiry Bearing Number	Dimensions	
		d (mm)	D (mm) B (mm)
SSr09 ZZ & 2RS	1.016	3.175	1.191
SSr0 ZZ & 2RS	1.191	3.967	1.588
SSr1 ZZ & 2RS	1.397	4.763	1.984
SSr1-4 ZZ & 2RS	1.984	6.35	3.571
SSr1-5 ZZ & 2RS	2.38	7.938	3.571
SSr2a ZZ & 2RS	3.175	12.7	4.366
SSr144 ZZ & 2RS	3.175	6.35	2.38
SSr2-5 ZZ & 2RS	3.175	7.938	3.571
SSr2 ZZ & 2RS	3.175	9.525	3.967
SSr2-6 ZZ & 2RS	3.175	9.525	3.571
SSr133 ZZ & 2RS	3.38	4.763	2.38
SSr155 ZZ & 2RS	3.967	7.938	3.175
SSr3 ZZ & 2RS	4.762	12.7	4.978
SSr3a ZZ & 2RS	4.763	15.875	4.978
SS1601 ZZ & 2RS	4.763	17.463	7.938
SSr156 ZZ & 2RS	4.763	7.938	3.175
SSr166 ZZ & 2RS	4.763	9.525	3.175
SSr4 ZZ & 2RS	6.35	15.875	4.978
SS1602 ZZ & 2RS	6.35	17.463	7.938
SSr4a ZZ & 2RS	6.35	19.05	5.558

英制不锈钢深沟球轴承

SSr188 ZZ & 2RS	6.35	9.525	3.175
SSr168 ZZ & 2RS	6.35	9.525	3.175
SSr1810 ZZ & 2RS	7.938	12.7	3.967
SS1603 ZZ & 2RS	7.938	22.225	8.733
SS1605 ZZ & 2RS	7.938	23.017	7.938
SS1604 ZZ & 2RS	9.525	22.225	8.733
SSr6 ZZ & 2RS	9.525	22.225	7.142
SS1606 ZZ & 2RS	9.525	23.017	7.938
SS1614 ZZ & 2RS	9.525	28.575	9.525
SS1607 ZZ & 2RS	11.113	23.017	7.938