

67 系列

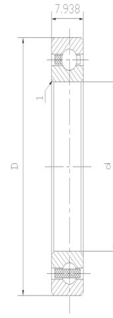

外形尺寸

基本额定载
荷(N)

重量

select Inquiry 型号

| | | | d(mm) | d(inch) | D(mm) | D(inch) | B(mm) | B(inch) | r min(mm) | r min(inch) | 动态(Cr) | 静态(Cor) | (kg) |
|------|----|--------|-------|---------|-------|---------|-------|---------|-----------|-------------|--------|---------|------|
| 6700 | 10 | 0.3937 | 15 | 0.5906 | 4 | 0.1575 | 0.1 | 0.0039 | 800 | 390 | 0.0019 | | |
| 6701 | 12 | 0.4724 | 18 | 0.7087 | 4 | 0.1575 | 0.2 | 0.0079 | 910 | 530 | 0.0031 | | |
| 6702 | 15 | 0.5906 | 21 | 0.8268 | 4 | 0.1575 | 0.2 | 0.0079 | 850 | 490 | 0.0036 | | |
| 6703 | 17 | 0.6693 | 23 | 0.9055 | 4 | 0.1575 | 0.2 | 0.0079 | 960 | 610 | 0.0040 | | |
| 6704 | 20 | 0.7874 | 27 | 1.0630 | 4 | 0.1575 | 0.2 | 0.0079 | 1030 | 720 | 0.0059 | | |
| 6705 | 25 | 0.9843 | 32 | 1.2598 | 4 | 0.1575 | 0.2 | 0.0079 | 1090 | 830 | 0.0070 | | |
| 6706 | 30 | 1.1811 | 37 | 1.4567 | 4 | 0.1575 | 0.2 | 0.0079 | 1170 | 980 | 0.0083 | | |
| 6707 | 35 | 1.3780 | 44 | 1.7323 | 5 | 0.1969 | 0.3 | 0.0118 | 1850 | 1630 | 0.0150 | | |
| 6708 | 40 | 1.5748 | 50 | 1.9685 | 6 | 0.2362 | 0.3 | 0.0118 | 2519 | 2234 | 0.0230 | | |
| 6709 | 45 | 1.7717 | 55 | 2.1654 | 6 | 0.2362 | 0.3 | 0.0118 | 2577 | 2401 | 0.0250 | | |
| 6710 | 50 | 1.9685 | 62 | 2.4409 | 6 | 0.2362 | 0.3 | 0.0118 | 2666 | 2636 | 0.0340 | | |